

TA*TR901TTP-020
 TA*TR9*1TTP-025
 TA*TR921TTP-040
 TA*TR921TTP-050

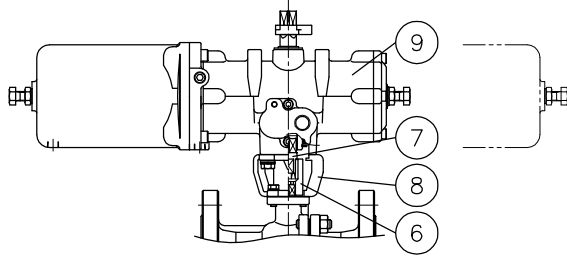

Size [mm]	d	L	D	C	n-h	W	W1	N	N1	H (): TAC	Weight [kg]	Cv P1/P2	Actuator		Sizing code
20	20	150	100	75	4-15	305	85	103	50	204	6.6	24	TAO-050	TAC-050	0
						305	85	103	50	211	8.6	40	TAO-050	TAC-050	0
25	25	170	125	90	4-19	367	102	119	52	226	11	100	TAO-063	TAC-063	2
						367	102	119	52	209(211)	14		TAO-063	TAC-063	0
40	40	200	140	105	4-19	435	120	142	59	282	18	170	TAO-080	TAC-080	2
						367	102	119	52	217(219)	16		TAO-063	TAC-063	0
50	50	230	155	120	4-19	435	120	142	59	290	20	240	TAO-080	TAC-080	2
						435	120	142	59	271	26		TAO-080	TAC-080	0
65	65	260	175	140	4-19	435	120	142	59	283	29	380	TAO-080	TAC-080	0
						530	147	174	71	314	35		TAO-100	TAC-100	2
80	80	280	185	150	8-19	530	147	174	71	340	48	680	TAO-100	TAC-100	0
						688	183	193	74	365	60		TAO-125	TAC-125	2

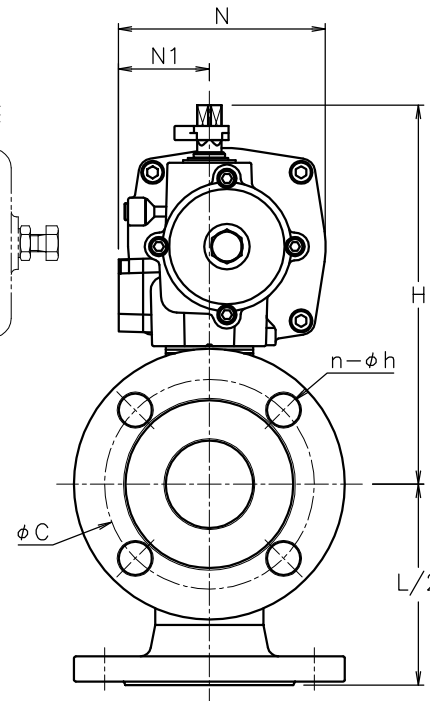
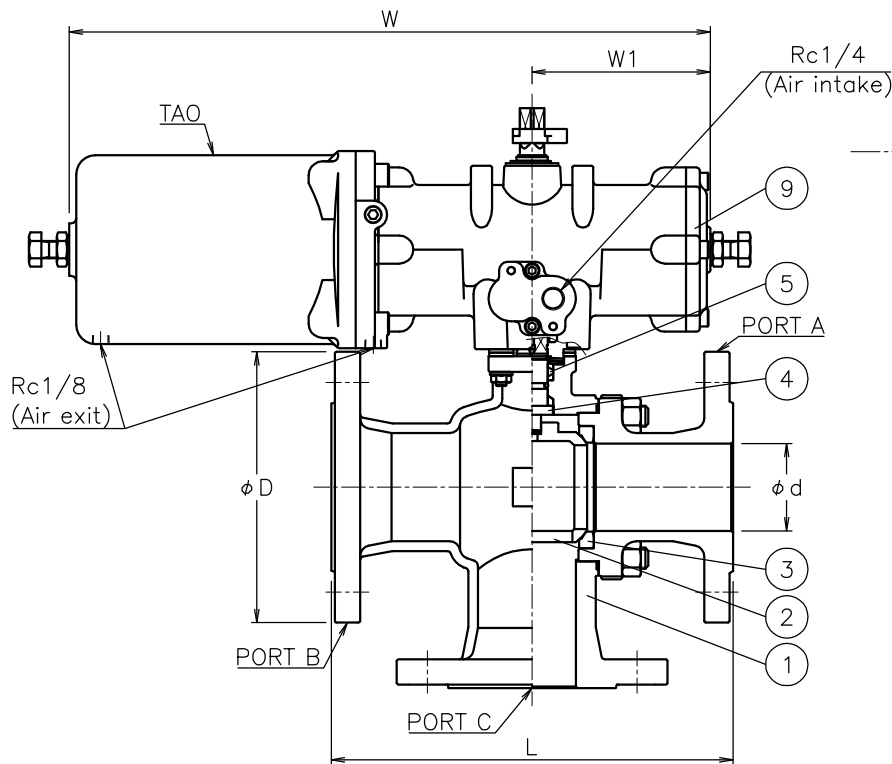

NOTE

- 1) Air supply: 0.4 to 0.5Mpa. Max 0.7Mpa.
- 2) Actuator operation

	Air to intake port	Spring return
TAO	P2	P1
TAC	P1	P2

This drawing is TAO.

Flow paths

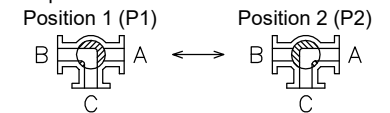

No	DESCRIPTION	MATERIALS	REQ'D	REMARKS
9	Actuator		1	TAO/C
8	Bracket	SCS13A	1	
7	Joint	SUS304	1	
6	Joint	SUS304	1	
5	Packing	R-PTFE	1set	
4	Stem	SUS304	1	
3	Seat	R-PTFE	2	
2	Ball	SUS304/SCS13A	1	
1	Body	SCS13A	1	

			APPR'D	H.F	TITLE	J10K Flanged-end (single-acting type) TR type pneumatic actuated 3 way ball valve				
			CHK'D	K.Y		MODEL	TAOTR9*1TTP TACTR9*1TTP			
			DESIGN		SCALE		NON	DWG No.	TR-9*1TTP-TD9-EN	
MARK	DATE	BY	DATE	'17-06-08						
REVISIONS										
MV-2622										