

Size [mm]	S	d	L	P	W	N	N1	H	Weight [kg]	Cv P1/P2	Actuator	Sizing code
15	Rc 1/2	13	75	1/8	110	57	32	161	1.8	5	TAD-040	0
				1/4	170	82	36	199	2.3		TAD-050	2
20	Rc 3/4	16	85	1/8	110	57	32	164	2.2	10	TAD-040	0
				1/4	170	82	36	202	2.7		TAD-050	2
25	Rc 1	20	100	1/4	170	82	36	173	3.1	16	TAD-050	0
					204	95	38	222	4.2		TAD-063	2
32	Rc1 1/4	25	115	1/4	170	82	36	178	3.9	25	TAD-050	0
					204	95	38	227	4.9		TAD-063	2

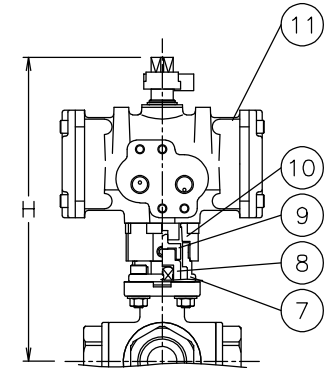
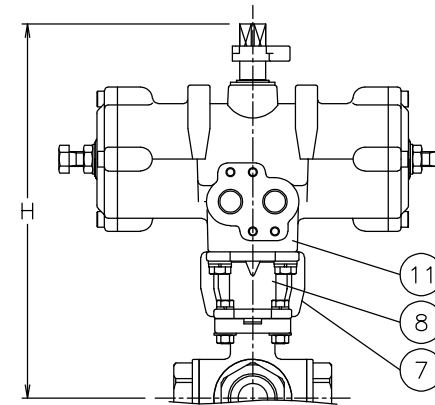
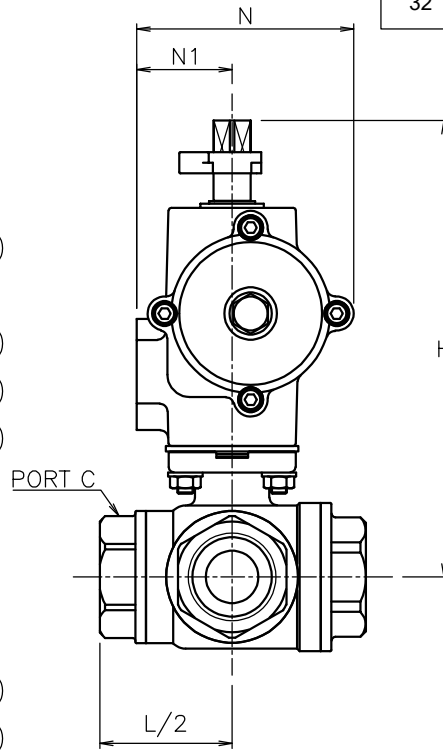
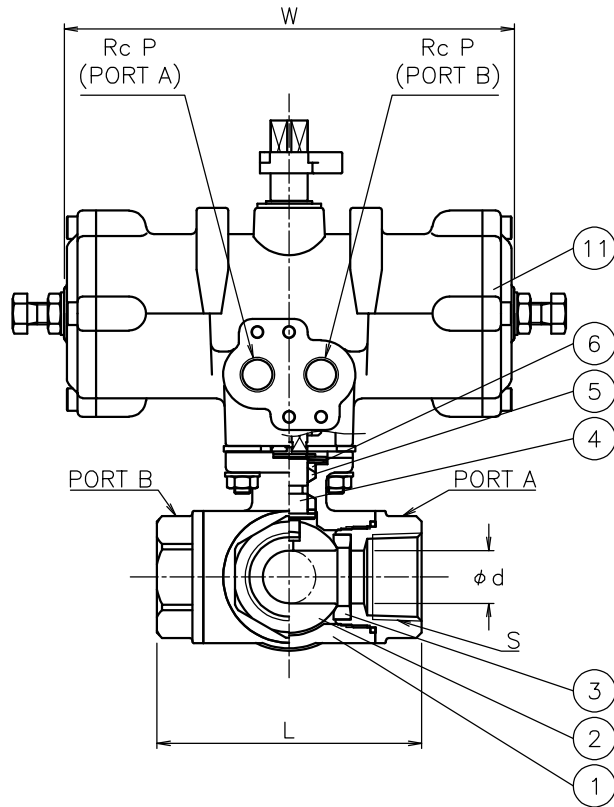

TADSL925UUF-015
TADSL925UUF-020
TADSL925UUF-025
TADSL925UUF-032

TADSL905UUF-015
TADSL905UUF-020

NOTE

- 1) Air supply: 0.4 to 0.5 Mpa. Max 0.7 Mpa.
- 2) Actuator operation
Air to port A : Position 1 (P1)
Air to port B : Position 2 (P2)

Flow paths (Top view of valve)

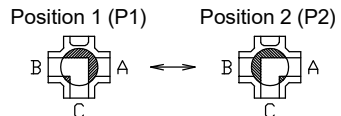

No	DESCRIPTION	MATERIALS	REQ'D	REMARKS
11	Actuator		1	TAD
10	Bracket	ZDC2	1	
9	Joint	SUS304	1	
8	Joint	SCS13A	1	
7	Bracket	SCS13A	1	
6	Packing	R-PTFE	1	
5	Packing	F-PTFE	1	
4	Stem	SUS316	1	
3	Seat	F-PTFE	4	
2	Ball	SCS14A	1	
1	Body	SCS14A	1	

MARK	DATE	BY	DATE	'21-09-21	SCALE	NON	DWG No.	SL-9*5UUF-TA4-EN	
REVISIONS									
MV-2927									
					APPR'D	H.F	TITLE		
					CHK'D	K.Y	Threaded End Rc (double-acting type) SL type pneumatic actuated 3 way ball valve		
					DESIGN		MODEL		
					DRAWN	S.O	TADSL9*5UUF		