

Valve DN	S	d	L	H1	H2	H	Weight (kg)	Cv ON/OFF	Actuator		Sizing code
15 A	Rc 1/2	8.5	58.2	29	68	157	2.7	3	TAO-040	TAC-040	0
20 A	Rc 3/4	11.5	60	32	70	159	2.8	6	TAO-040	TAC-040	0
25 A	Rc 1	15	73.5	39	73	163	3	9	TAO-040	TAC-040	0

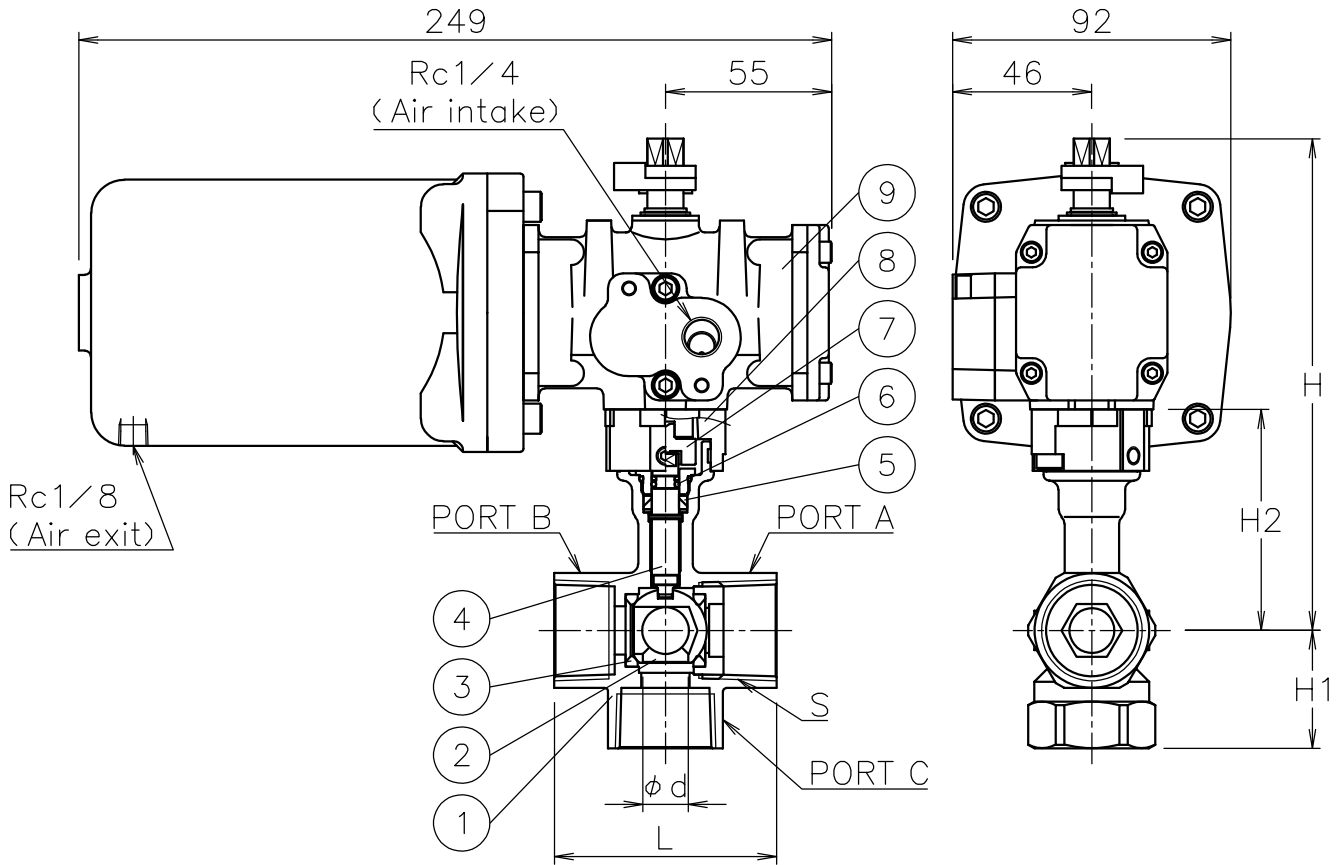

NOTE

1. Air supply : 0.4~0.5 Mpa max 0.7 Mpa
2. Actuator operation
 - TAO serie
 - Air to intake port : Position 2
 - Spring return : Position 1
 - TAC serie
 - Air to intake port : Position 1
 - Spring return : Position 2

Flow paths

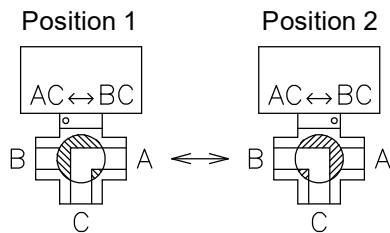

9	Actuator		1	TAO/C
8	Bracket	BERIC	1	
7	Joint	SUS304	1	
6	O-ring	FKM	1	
5	Packing	PTFE	1	
4	Stem	SUS304	1	
3	Seat	R-PTFE	2	
2	Ball	SUS304	1	
1	Body	SCS13A	1	
No	DESCRIPTION	MATERIALS	REQ'D	REMARKS

			APPR'D	H.F	Valve DN: 15~25 A TITLE Threaded End Rc (single-acting type) TE type pneumatic actuated 3 way ball valve MODEL TAOTE905TTP TACTE905TTP SCALE NON DWG No. TE-905TTP-TD2a-EN							
			CHK'D	K.Y								
			DESIGN									
			DRAWN	P.O								
MARK	DATE	BY	DATE	'16-04-11								
REVISIONS												
MV-2167												