

Valve DN	S	d	L	H1	H2	H	Weight (kg)	Cv ON/OFF	Actuator	Sizing code
15 A	Rc 1/2	8.5	58.2	29	68	157	1.3	3	TAD-040	0
20 A	Rc 3/4	11.5	60	32	70	159	1.4	6	TAD-040	0
25 A	Rc 1	15	73.5	39	73	163	1.6	9	TAD-040	0

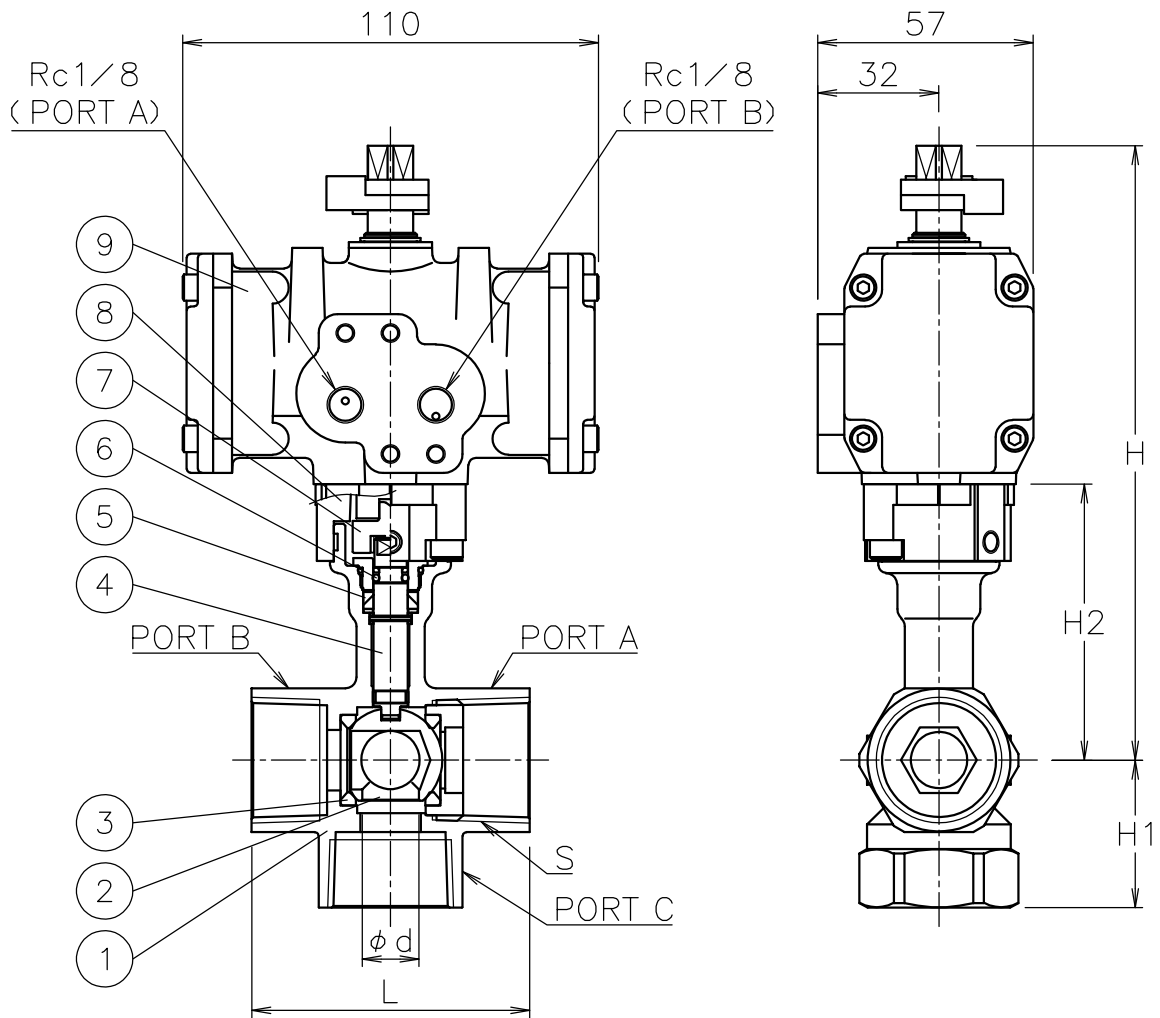

**NOTE**

1. Air supply : 0.4~0.5 Mpa max 0.7 Mpa
2. Actuator operation
  - Air to port A : Position 1
  - Air to port B : Position 2

**Flow paths**

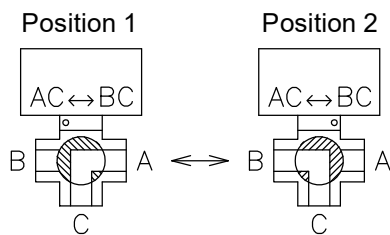

9	Actuator		1	TAD
8	Bracket	BERIC	1	
7	Joint	SUS304	1	
6	O-ring	FKM	1	
5	Packing	PTFE	1	
4	Stem	SUS304	1	
3	Seat	R-PTFE	2	
2	Ball	SUS304	1	
1	Body	SCS13A	1	
No	DESCRIPTION	MATERIALS	REQ'D	REMARKS

			APPR'D	H.F	Valve DN: 15~25 A TITLE Threaded End Rc (double-acting type) TE type pneumatic actuated 3 way ball valve MODEL TADTE905TTP					
			CHK'D	K.Y						
			DESIGN							
			DRAWN	P.O						
MARK	DATE	BY	DATE	'16-04-11	SCALE	NON	DWG No.	TE-905TTP-TA2a-EN		
REVISIONS										
MV-2167										