

Valve DN	S	d	L	H1	H	Weight (kg)	Cv ON/OFF	Actuator	Sizing code
15 A	Rc 1/2	8.5	58.2	29	112	0.5	3	PND-03S	0
20 A	Rc 3/4	11.5	60	32	114	0.6	6	PND-03S	0
25 A	Rc 1	15	73.5	39	118	0.7	9	PND-03S	0

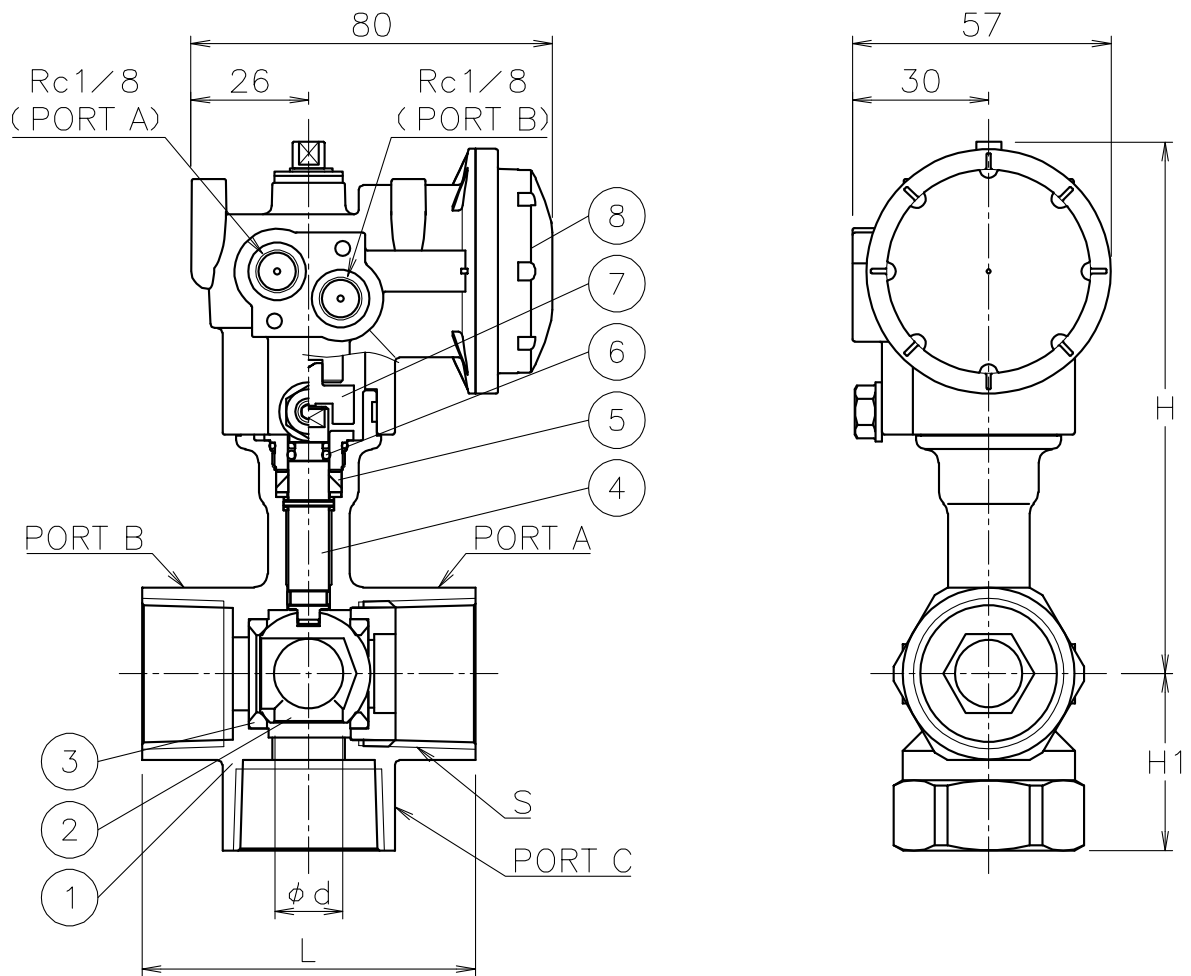

NOTE

1. Air supply : 0.4~0.5 Mpa max 0.7 Mpa
2. Actuator operation
 - Air to port A : Position 1
 - Air to port B : Position 2
3. Coupling OD must be less than $\phi 14.5$

Flow paths

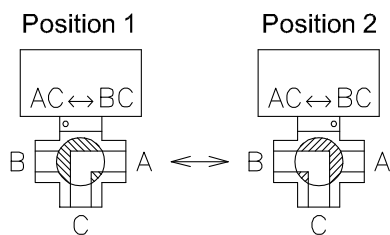

8	Actuator	PPS body	1	PND
7	Joint	SUS304	1	
6	O-ring	FKM	1	
5	Packing	PTFE	1	
4	Stem	SUS304	1	
3	Seat	R-PTFE	2	
2	Ball	SUS304	1	
1	Body	SCS13A	1	
No	DESCRIPTION	MATERIALS	REQ'D	REMARKS

			APPR'D	K.Y	TITLE	Valve DN: 15~25 A				
			CHK'D	K.Y		Threaded End Rc (double-acting type)				
			DESIGN			TE type pneumatic actuated 3 way ball valve				
			DRAWN	T.A		MODEL	PNDTE905TTP			
MARK	DATE	BY	DATE	'22-12-09	SCALE	NON	DWG No.	TE-905TTP-NA1-EN		
REVISIONS										
MV-2987										