

Valve DN	S	d	L	H1	H2	H	Weight(kg)		Cv ON/OFF	Actuator		Sizing code
							AH1	DM*				
15 A	Rc 1/2	8.5	58.2	29	85 (58)	174 (147)	1.3	1.5 (1.1)	3	AH1-030	DM*-030	0
20 A	Rc 3/4	11.5	60	32	85 (58)	176 (149)	1.4	1.6 (1.2)	6	AH1-030	DM*-030	0
25 A	Rc 1	15	73.5	39	85 (58)	179 (152)	1.6	1.8 (1.4)	9	AH1-030	DM*-030	0

( ) : DM2-030

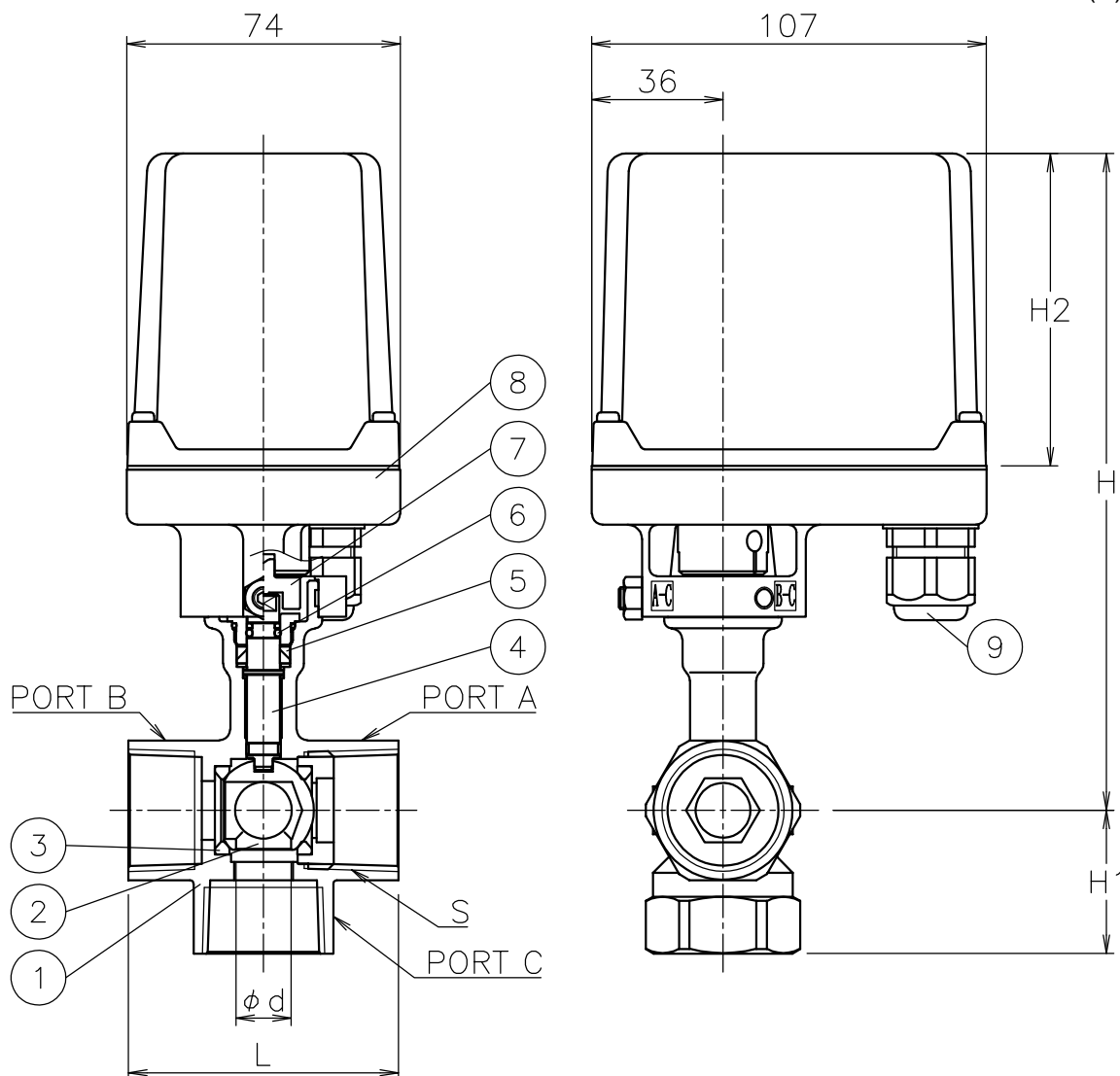

**NOTE**

(a) Cable acceptance  $\phi 5 \sim 10.5\text{mm}$

**Flow paths**

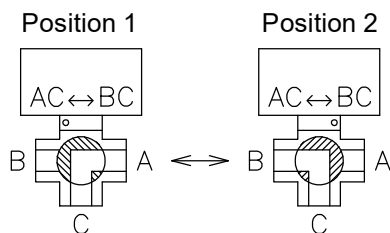

9	Cable gland	NYLON 6	1	G 3/8 (a)
8	Actuator	ADC12/PC Cover	1	
7	Joint	SUS304	1	
6	O-ring	FKM	1	
5	Packing	PTFE	1	
4	Stem	SUS304	1	
3	Seat	R-PTFE	2	
2	Ball	SUS304	1	
1	Body	SCS13A	1	

No	DESCRIPTION	MATERIALS	REQ'D	REMARKS
----	-------------	-----------	-------	---------

			APPR'D	H.F	TITLE	Threaded End Rc Valve DN: 15~25 A TE type motorized 3 way ball valve						
			CHK'D	K.Y		MODEL	AH1TE*05TTP DM0TE005TTP DM2TE005TTP					
			DESIGN		SCALE		NON	DWG No.	TE-05TTP-CM2a-EN			
			DRAWN	P.O								
MARK	DATE	BY	DATE	'16-04-08								
REVISIONS												
MV-2167												