

Size [mm]	S	d	L	H	Weight [kg]	Cv P1/P2	Actuator	Sizing code
8	Rc 1/4	8.5	47	90	0.8	1.8	CA1-015	0
10	Rc 3/8	9.2	47	90	0.7	2.2	CA1-015	0
15	Rc 1/2	13	67	93	0.9	5	CA1-015	0

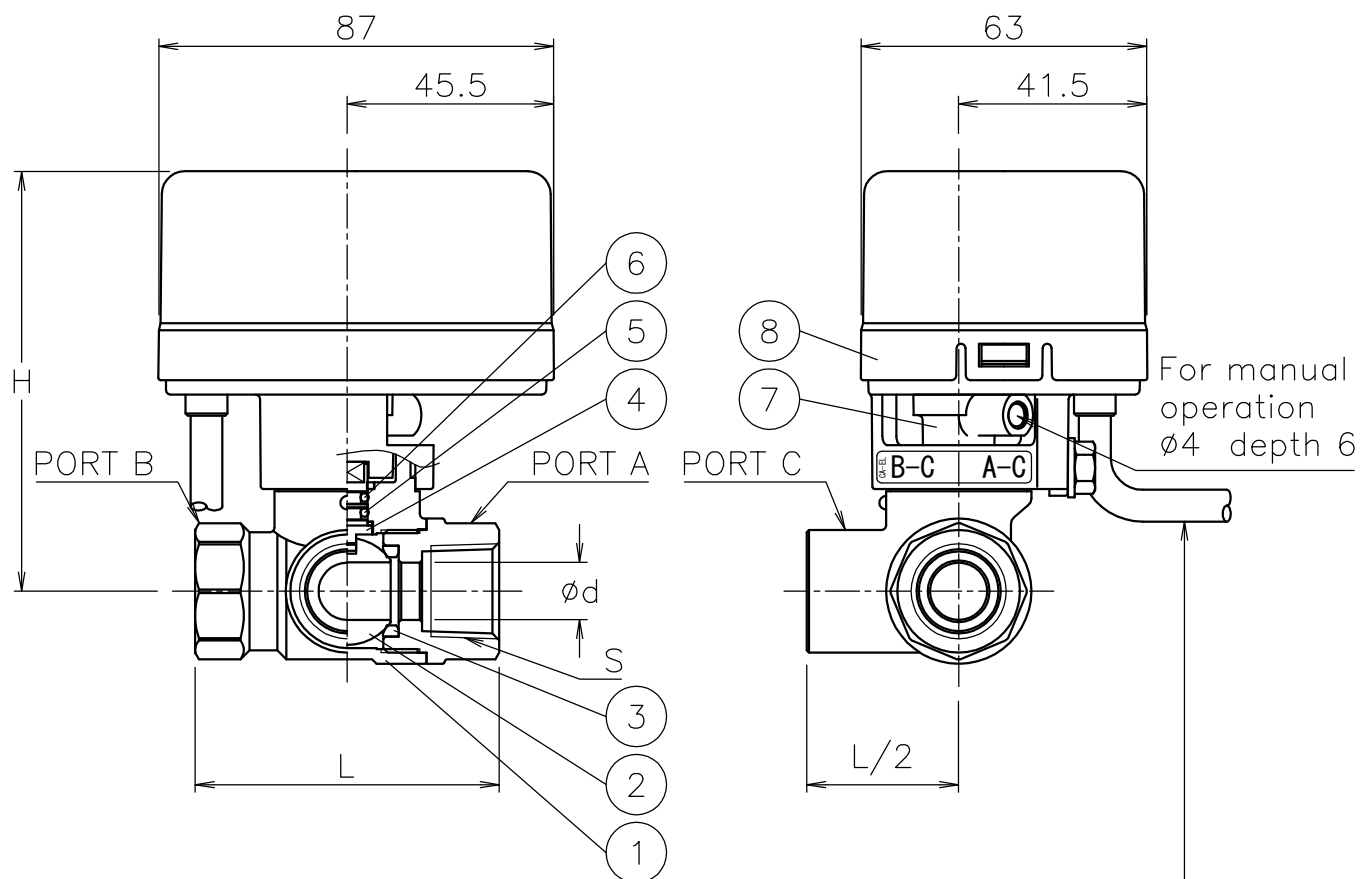

Flexible cable  
5 leads 0.5mm<sup>2</sup> L=500 mm

Flow paths (Top view of valve)

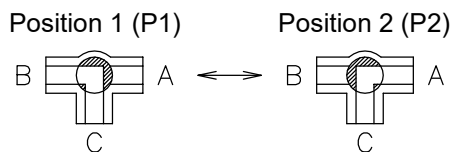

8	Actuator	PC Case	1	
7	Joint	PPS	1	
6	O-ring	NBR	1	
5	O-ring	FKM	1	
4	Stem	SUS316	1	Cr plated
3	Seat	PTFE	2	
2	Ball	SUS316	1	
1	Body	SCS14A	1	
No	DESCRIPTION	MATERIALS	REQ'D	REMARKS

			APPR'D	H.F	TITLE	Threaded End Rc EL type motorized 3 way ball valve				
			CHK'D	K.Y		MODEL	CA1EL*05UUT			
			DESIGN		MARK		DATE	BY	DATE	'19-07-16
			DRAWN	S.O			SCALE	NON	DWG No.	EL-05UUT-CA6-EN
REVISIONS			 <b>NIPPON VALVE CONTROLS, INC.</b>							
MV-2778										